

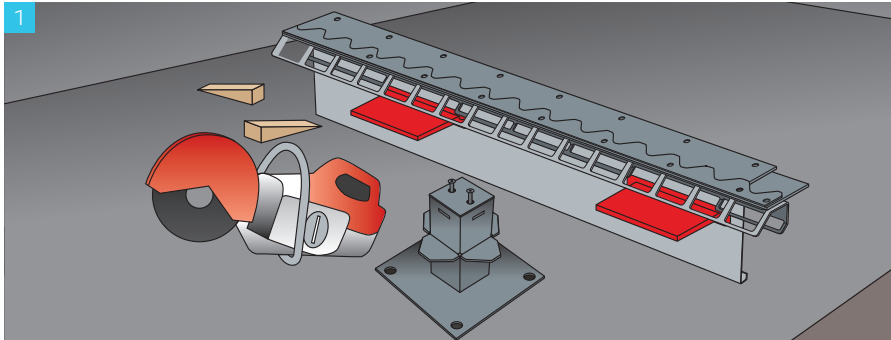

Installation Guide

Isedio ShieldJoint



Set up laser dumpy level on-site, ensuring you have finished floor level (FFL) datum and relevant hand tools available. Ensure sub-base has been correctly prepared and relevant membranes placed.

Handle parts with care, ensuring not to drop or damage them while unloading from transport and moving to site for installation.

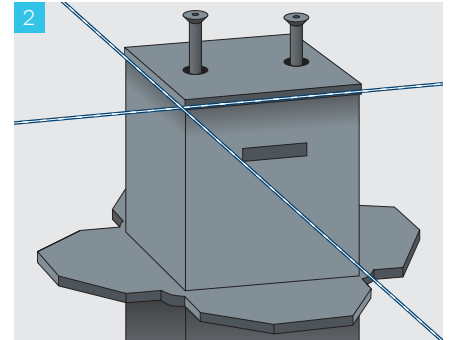

Set up string lines along the joint lines at the finished floor level.

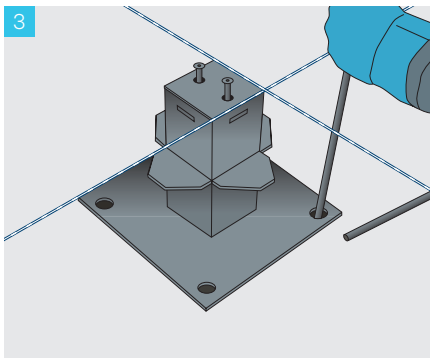

Position the intersection post and pin in place. Remove the cap and use the internal adjustment bolt for height adjustment. Adjust height ensuring cap surface is level with the finished floor level.

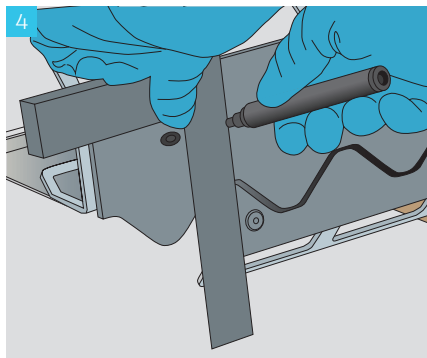

Cut the end of the first ShieldJoint, ensuring it is square, to butt up against the intersection post.

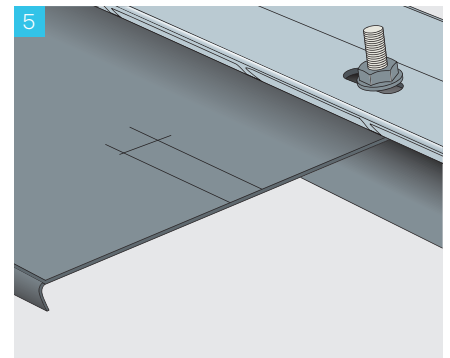

Cut away a slot for the load transfer plate on the intersection post and fold back to the fixed side of the joint (non sleeve side) or remove completely.



Fit ArmourFix jacks to the ShieldJoint with ShieldJoint jack fittings (these can be ordered separately).

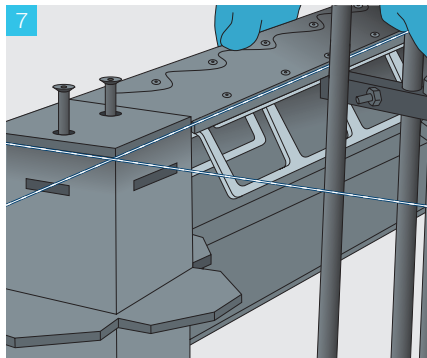

Position ShieldJoint with jacks fitted up against the intersection post. Ensure the cut end is fitted up against the intersection post.

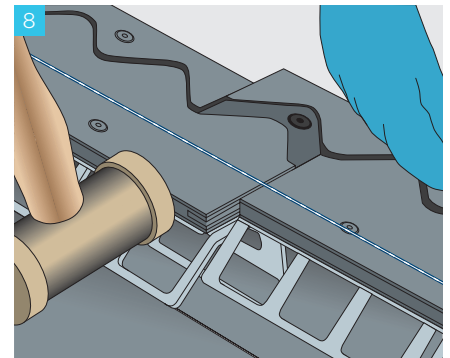

Continue to fit ShieldJoint with jacks along the joint line using a soft face mallet to secure the top plates together.

Installation Guide

Istedio ShieldJoint

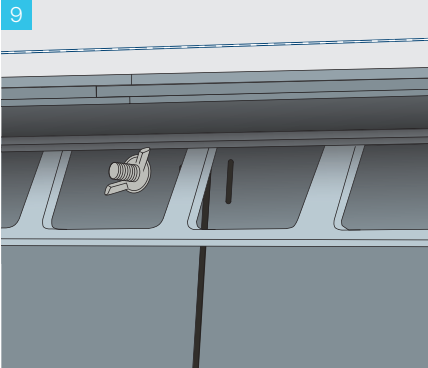

Join the lengths using the nylon bolts and wingnuts supplied.

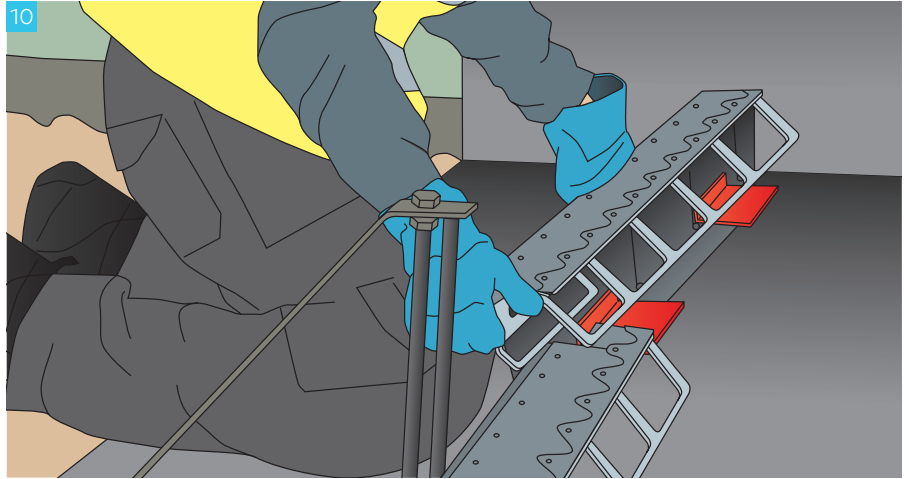

Measure the distance for the final piece along the joint line, and cut the ShieldJoint piece to length, ensuring it is square at the wall end. Also ensure an allowance is made for any isolation material required between the slab and the wall / fixture.

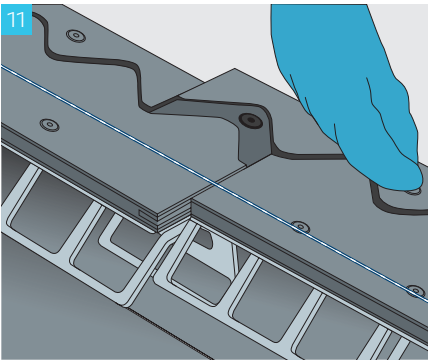

Continue in other directions where required.

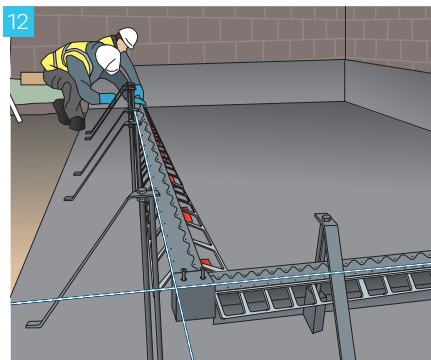

Manually position ShieldJoint sections in line with the string line.



Pin ArmourFix jacks into place. Do not use pin and welding installation method as it may result in misalignment of the joint.

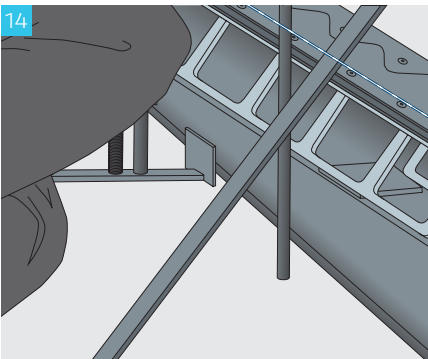

Drive pins in near to ShieldJoint sections, between the ArmourFix jacks.

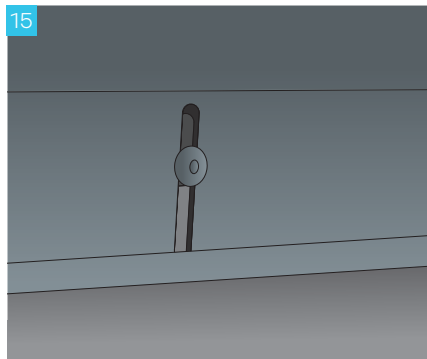

If using adjustable divider plates, ensure the divider plate is dropped to the sub-base level.

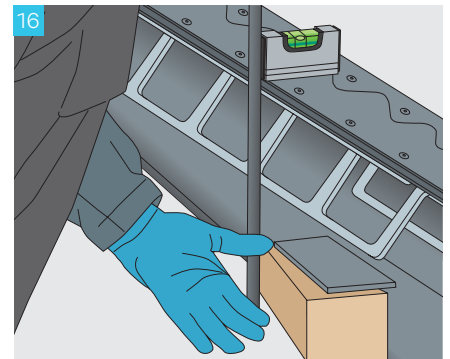

Place a small spirit level across the width of the ShieldJoint top plate and use wooden wedges between the pins and the ShieldJoint to adjust the top plate ensuring it is level. This is a critical point as the top surface of the installed joint must be level.

Installation Guide

Isedio ShieldJoint

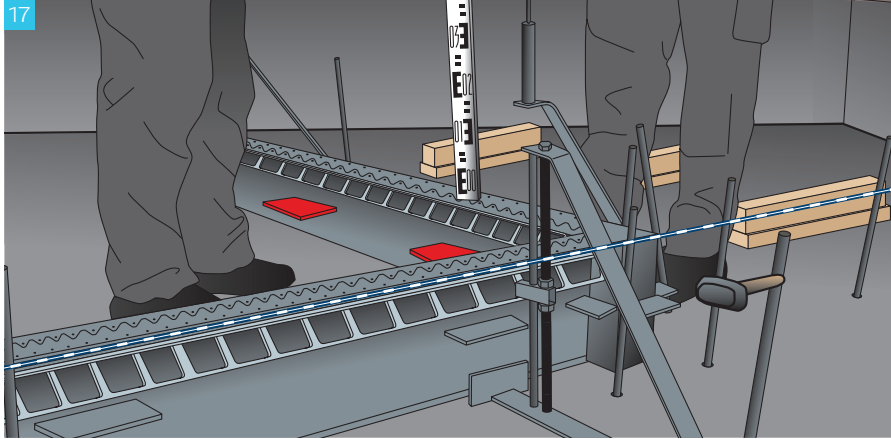

Check and adjust ShieldJoint height to the finished floor level using a staff and laser level.

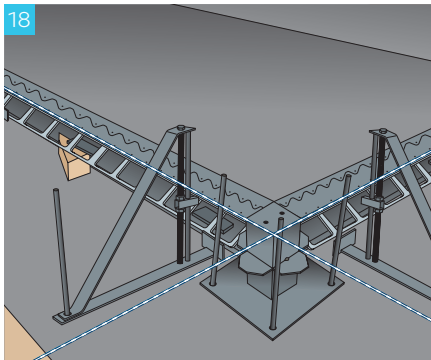

Double check that the joints are in line with the string line and adjust if necessary. Care should be taken to not step on or place reinforcing bar mesh on the plate dowels to prevent misalignment of the joints.

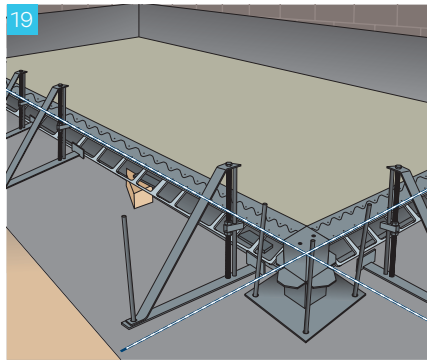

Cast concrete, checking and adjusting for height and level as necessary. Before the next pour, ensure all installation jacks and pins have been removed.

Watch the
installation
video here

